

PROPRIETARY NOTICE: This document contains proprietary information of AAT Inc. neither the document nor said proprietary information shall be published, reproduced, copied, disclosed or used for any purpose other than consideration of this document without the express written permission of a duly authorized representative of said Company.

REVISIONS			
SYM	DESCRIPTION	DATE	APPROVED
B	SEE ECO 8338	07/28/08	

NOTES: UNLESS OTHERWISE SPECIFIED.

▲ MOUNTING SCREWS AND O-RING SUPPLIED BY AEROANTENNA.

2. LABEL SIZE, SHAPE, CONTENTS AND LOCATION ARE SUBJECT TO CHANGE WITHOUT NOTICE.

3. TOLERANCE: .XX = ±.03
.XXX = ±.010

SPECIFICATION:

FREQUENCY: 1575.42 ±10.23 MHz
POLARIZATION: RIGHT HAND CIRCULAR
AXIAL RATIO: 3 dB MAX AT BORE SIGHT
RELATIVE RADIATION COVERAGE: PER DO-301

AMPLIFIER:
GAIN: 29.5± 3 dB
NOISE FIGURE: 2.5 dB MAX. @ 25°C
IMPEDANCE: 50 OHMS
VSWR: ≤1.5:1
POWER HANDLING: 1 WATT
VOLTAGE: 4.5-15 VDC
CURRENT: 60 mA MAX

FINISH: WHITE, WEATHERABLE POLYMER
CONNECTOR: TNC F
WEIGHT: 7.0 OZ
ALTITUDE: 55,000'
OPERATING TEMP: -55°C TO +70°C
STORAGE TEMP: -55°C TO +85°C
DESIGNED TO: DO-160E,

ENV CAT: F2-AB[BD][S(CLMY)U(FF1)]X[SY]FSXSZXXX[ZCZW]YH[A4J44][2A]CAC
ARINC 743, RTCA/DO-301

TSO: C190

PART NO. DESIGNATION:

AT575-333XXX-XXXX-XXX-XX-XX-XX

CUSTOMER ID (IF APPLICABLE) _____
COLOR _____
CONNECTOR _____
CABLE LENGTH _____
* 000 = IN INCHES

MAGNET
NM = NO MAGNET
GAIN (± 3 db)
29.5 = 29.5 db (60 mA MAX)
VOLTAGE
RG = 4.5-15 VDC

* = OPTION NOT AVAILABLE WITH THIS MODEL
STANDARD MODEL = AT575-333W-TNCF-000-RG-29.5-NM



03-9243358 :קפפ ▪ 03-9243352 :70 ▪ ת"פ 7042 .T.T.14 דודיא ת"ר
www.hypertech.co.il ▪ sales@hypertech.co.il

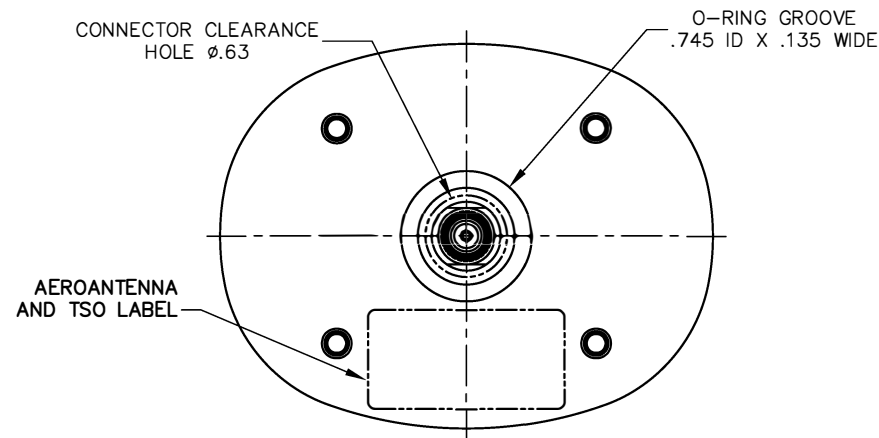
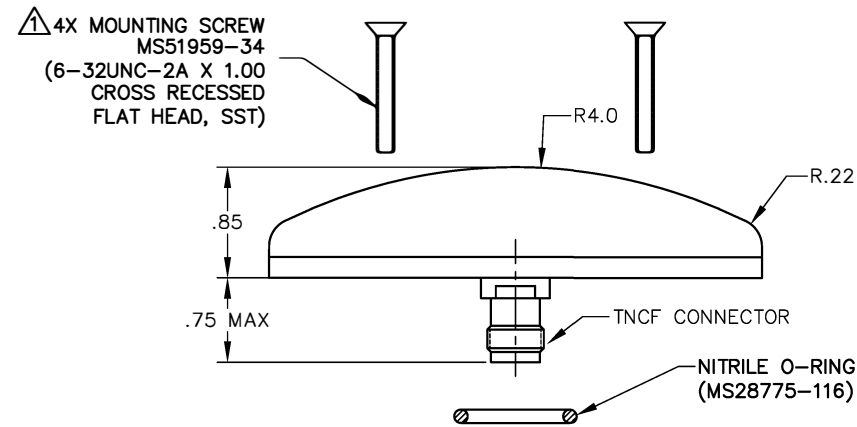
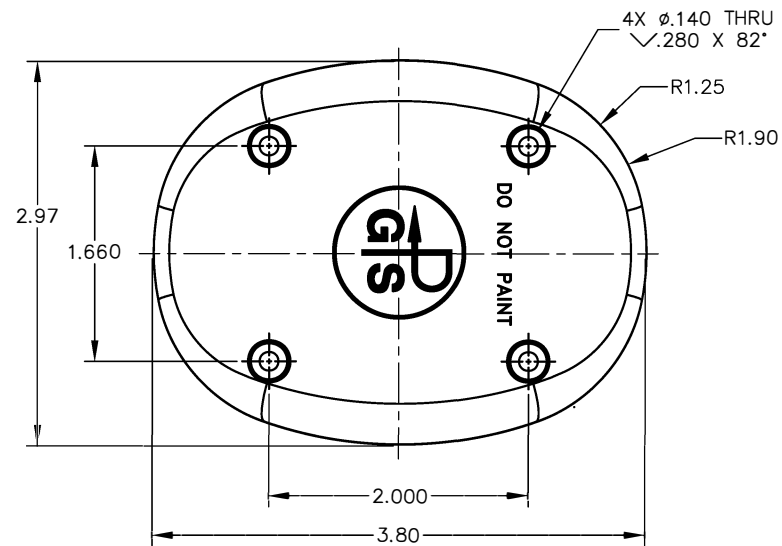

DO NOT SCALE THIS DRAWING REMOVE BURRS AND BREAK SHARP EDGES: PART TO BE CLEAN AND OIL FREE ALL DIMENSIONS ARE IN INCHES DIMENSIONING & TOLERANCING PER ASME Y14.5M-1994 TOLERANCES: XX ±.01 FRACT = ±1/32 XXX ±.005 ANG. = ±1/2'		DRAWN J. GUTIERREZ 10/31/07				
✓ SURFACE ROUGHNESS MACHINED PARTS V63 MOLDED PARTS V32 HOLE DIA. TOLERANCE .0135 - .125 +.004 -.001 .126 - .250 +.005 -.001 .251 - .500 +.008 -.001 .501 - .750 +.008 -.001		CHECKED ANTHONY D. 11-09-07			TITLE GPS ANTENNA	
NEXT ASSY		ENGR KRIT R. 11-09-07	SIZE B	CAGE CODE OUVG2	DRAWING NO. AT575-333	REV B
		MFG D. LEVY 11-09-07	SCALE NONE I:\CAD\AT575\333\AT575-333_B SHEET 1 OF 1			
		Q.A. B. RUBENI 11-09-07				
		APPROVED G. SHAR 11-09-07				
		DRAWN IN MCAD				